

# ELECTRIC TOOL PARTS LIST

**ORBITAL SANDER**

1990-1-17

Model SV 12

SV 12(E4)

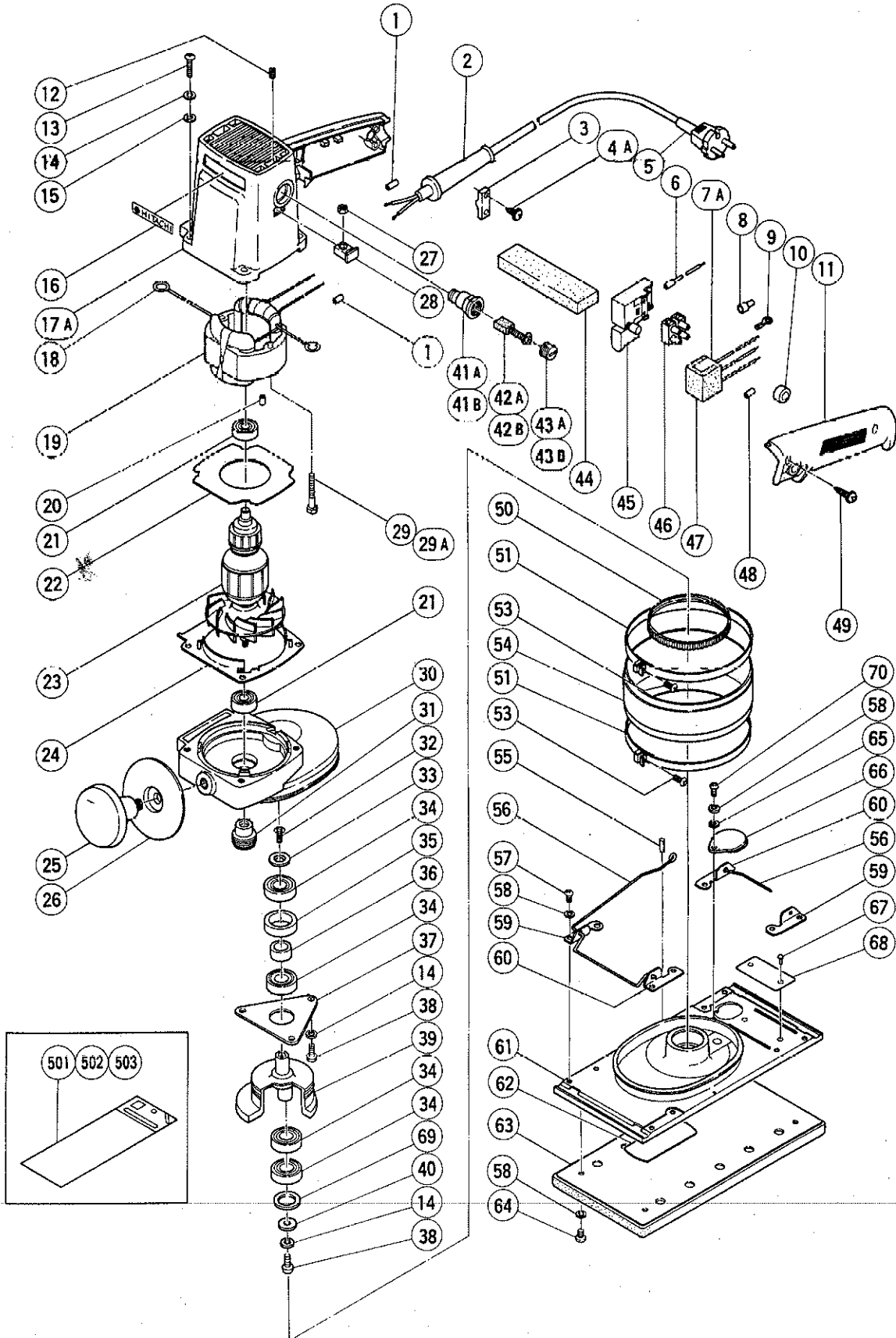

## PARTS

SV 12

ITEM NO.	CODE NO.	DESCRIPTION	NO. USED	REMARKS
1	981-373	TUBE (D)	4	
* 2	953-327	CORD ARMOR D8.8	1	
* 2	938-051	CORD ARMOR D10.1	1	
3	937-631	CORD CLIP	1	
4A	984-750	TAPPING SCREW (W/FLANGE) D4X16	2	
* 5	500-212Z	CORD	1	(CORD ARMOR D8.8)
* 5	500-201Z	CORD	1	(CORD ARMOR D10.1)FOR CHN
* 5	500-223Z	CORD	1	(CORD ARMOR D10.1)FOR SIN,KUW
* 5	500-226Z	CORD	1	(CORD ARMOR D8.8)FOR NZL,NGU,AUS
* 5	500-231Z	CORD	1	(CORD ARMOR D8.8)FOR GBR,SAF
* 5	500-234Z	CORD	1	(CORD ARMOR D8.8)FOR INA,SUR
* 5	500-240Z	CORD	1	(CORD ARMOR D8.8)FOR USA,CAN
* 5	500-245Z	CORD	1	(CORD ARMOR D10.1)FOR SYR
* 5	500-247Z	CORD	1	(CORD ARMOR D10.1)FOR ITA,FRG,FRA,HOL,DEN,FIN,SWE,AUT
* 5	500-248Z	CORD	1	(CORD ARMOR D10.1)FOR SUI
* 6	953-328Z	INTERNAL WIRE	1	FOR HOL,DEN,FIN,SWE,AUT,NZL,GBR,SAF,FRG,FRA,SUI
7A	994-273	NOISE SUPPRESSOR	1	
* 8	959-140	CONNECTOR 50091 (10 PCS.)	1	FOR HOL,DEN,FIN,SWE,AUT,NZL,GBR,SAF,FRG,FRA
* 9	959-146	TERMINAL 50061 (10 PCS.)	1	FOR SWE,SUI,NZL,GBR,SAF,DEN,AUT
* 9	961-419Z	TERMINAL	1	FOR FRG,FRA,FIN,AUT
* 9	983-504	TERMINAL	1	FOR HOL
10	940-811	PUSHING HOLDER	1	
11	953-323	HANDLE COVER	1	
12	962-782	HEX. SOCKET SET SCREW M5X6	2	
13	949-241	MACHINE SCREW M5X20 (10 PCS.)	4	
14	949-454	SPRING WASHER M5 (10 PCS.)	8	
15	949-424	WASHER M5 (10 PCS.)	4	
16	950-565	HITACHI LABEL	1	
17A	990-801	HOUSING ASS'Y	1	INCLUD.12,29A,41B
18	930-630	BRUSH TERMINAL	2	
* 19	983-501C	STATOR ASS'Y 110V-115V	1	INCLUD.1,18
* 19	983-501E	STATOR ASS'Y 220V-230V	1	INCLUD.1,18
* 19	983-501F	STATOR 240V	1	INCLUD.1,18
* 19	983-501G	STATOR ASS'Y 240V	1	INCLUD.1,18 FOR AUS
* 19	983-501H	STATOR ASS'Y 110V	1	INCLUD.1,18 FOR GBR
* 19	983-501J	STATOR ASS'Y 220V-230V	1	INCLUD.1,18 FOR EUROPE,SAF
* 19	983-501K	STATOR ASS'Y 240V	1	INCLUD.1,18 FOR GBR
* 19	983-501L	STATOR ASS'Y 230V	1	INCLUD.1 FOR NZL
20	931-701	BEARING LOCK	1	
21	608-VVM	BALL BEARING 608VVMC2EPS2L	2	
22	953-362	INNER GUIDE (B)	1	
* 23	983-502C	ARMATURE 110V-115V	1	
* 23	983-502E	ARMATURE 220V-230V	1	
* 23	983-502F	ARMATURE 240V	1	
* 23	983-502G	ARMATURE 220V-230V	1	FOR EUROPE,SAF
* 23	983-502H	ARMATURE 240V	1	FOR GBR
* 23	983-502J	ARMATURE 110V	1	FOR GBR
24	953-307	FAN GUIDE	1	
25	953-324	HANDLE KNOB	1	
26	953-334	PLATE	1	
27	949-555	NUT M5 (10 PCS.)	2	TILL 9.1987
28	953-232	NUT COVER	2	TILL 9.1987

\* : ALTERNATIVE PARTS

01-90

## PARTS

SV 12

ITEM NO.	CODE NO.	DESCRIPTION	NO. USED	REMARKS
29	949-247	MACHINE SCREW M5X35 (10 PCS.)	2	TILL 9.1987
29A	980-864	HEX. HD. TAPPING SCREW D5X40	2	SINCE 10.1987
30	983-494Z	FRAME	1	
31	983-492Z	PULLEY (A)	1	
32	949-332	FLAT HD. SCREW M5X12 (10 PCS.)	1	
33	953-338	WASHER	1	
34	600-1DD	BALL BEARING 6001DDUCMPS2S	4	
35	983-504Z	SLEEVE (B)	1	
36	983-500Z	SLEEVE (A)	1	
37	983-493Z	BEARING COVER	1	
38	949-237	MACHINE SCREW M5X12 (10 PCS.)	4	
39	983-499Z	PULLEY (B)	1	
40	953-314	WASHER	1	
41A	931-265	BRUSH HOLDER	2	TILL 4.1984
41B	990-721	BRUSH HOLDER	2	SINCE 5.1984
42A	999-035	CARBON BRUSH (1 PAIR)	2	TILL 4.1984
42B	999-021	CARBON BRUSH (1 PAIR)	2	SINCE 5.1984
43A	931-266	BRUSH CAP	2	TILL 4.1984
43B	937-847	BRUSH CAP	2	SINCE 5.1984
44	944-483	SUPPORT	1	
45	971-667Z	SWITCH (2P PILLAR TYPE) W/LOCK	1	
* 46	958-308Z	PILLAR TERMINAL (A)	1	FOR SUI
* 47	930-153	SUPPORT (B)	1	FOR SWE,SUI,NZL,SAF,HOL,DEN
* 48	959-142	CONNECTOR 50096 (10 PCS.)	1	FOR SUI
49	982-095	TAPPING SCREW (W/WASHER) D4X20	2	
50	953-312	BELT	1	
51	983-491Z	SEAL BAND	2	
53	949-232	MACHINE SCREW M4X28 (10 PCS.)	2	
54	983-490Z	RUBBER SEAL	1	
55	949-861	ROLL PIN D2X12 (10 PCS.)	2	
56	982-094	SPRING (B)	2	
57	949-215	MACHINE SCREW M4X8 (10 PCS.)	8	
58	949-453	SPRING WASHER M4 (10 PCS.)	14	
59	982-092	SPRING HOLDER (A)	2	
60	982-093	SPRING HOLDER (B)	2	
61	983-497Z	BOTTOM PLATE	1	
62	983-495Z	BEARING SEAL	1	
63	983-498Z	FELT PAD	1	
64	949-214	MACHINE SCREW M4X6 (10 PCS.)	4	
65	949-423	WASHER M4 (10 PCS.)	1	
66	983-496Z	CAP	1	
* 67	949-510	RIVET D2.5X4.8 (10 PCS.)	1	FOR USA,CAN
68		NAME PLATE	1	
69	983-620	WASHER (A)	1	
70	949-216	MACHINE SCREW M4X10 (10 PCS.)	1	

