

# ELECTRIC TOOL PARTS LIST

**BELT SANDER**  
**Model SB-110**

1991 · 2 · 20  
 (E8)

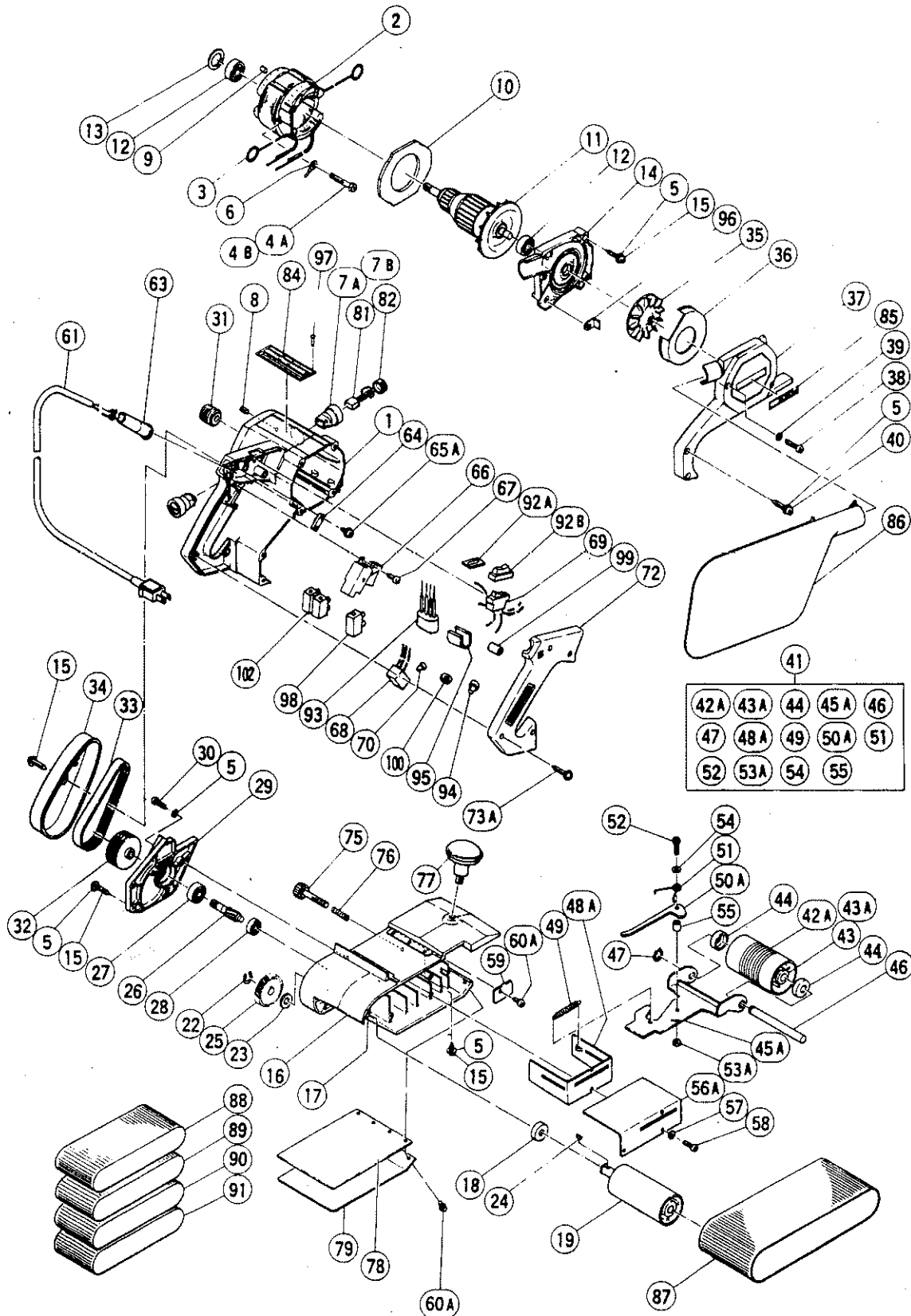

## PARTS

SB - 110

ITEM NO.	CODE NO.	DESCRIPTION	NO. USED	REMARKS	
*	1	986-770	HOUSING ASS'Y	1	INCLUD.7B,8
*	1	986-771	HOUSING ASS'Y	1	INCLUD.7B,8 FOR USA
*	1	986-772	HOUSING ASS'Y	1	INCLUD.7B,8 FOR AUT
*	2	953-032C	STATOR ASS'Y 110V - 115V	1	INCLUD.3
*	2	953-032D	STATOR ASS'Y 120V - 127V	1	INCLUD.3
*	2	953-032E	STATOR ASS'Y 220V - 230V	1	INCLUD.3
*	2	953-032F	STATOR ASS'Y 240V	1	INCLUD.3
*	2	953-032G	STATOR ASS'Y 220V - 230V	1	INCLUD.3 FOR NZL
*	2	953-032H	STATOR ASS'Y 240V	1	INCLUD.3 FOR AUS
*	2	953-032J	STATOR ASS'Y 115V	1	INCLUD.3 FOR USA
*	2	953-119C	STATOR ASS'Y 110V - 115V	1	INCLUD.3 FOR GBR
*	2	953-119E	STATOR ASS'Y 220V - 230V	1	INCLUD.3 FOR NOR
*	2	953-119F	STATOR ASS'Y 240V	1	INCLUD.3 FOR GBR
*	2	953-119G	STATOR ASS'Y 230V	1	INCLUD.3 FOR SAF
*	2	953-119K	STATOR 220V	1	FOR ITA,FRG,FRA,HOL,DEN,SWE,AUT,ESP
	3	948-703	BRUSH TERMINAL	2	
	4A	949-249	MACHINE SCREW M5X45 (10 PCS.)	2	TILL 9.1979
	4B	953-121	HEX. HD. TAPPING SCREW D5X50	2	SINCE 10.1979
	5	949-454	SPRING WASHER M5 (10 PCS.)	15	
*	6	953-033	INTERNAL WIRE	1	
*	7A	953-123Z	BRUSH HOLDER	2	TILL 8.1983 FOR AUT
*	7B	986-773	BRUSH HOLDER	2	SINCE 7.1983
*	7B	986-774	BRUSH HOLDER	2	SINCE 7.1983 FOR AUT
	8	949-368	SLOTTED HD. SET SCREW M4X10 (10 PCS.)	2	
	9	948-362	BEARING LOCK	1	
	10	953-035	FAN GUIDE	1	
*	11	953-037C	ARMATURE 110V - 115V	1	
*	11	953-037D	ARMATURE 120V - 127V	1	
*	11	953-037E	ARMATURE 220V - 230V	1	
*	11	953-037F	ARMATURE 240V	1	
*	11	953-120G	ARMATURE 220V - 230V	1	FOR SAF,HOL
*	11	953-120H	ARMATURE 240V	1	FOR GBR
	11	953-120J	ARMATURE 110V - 115V	1	FOR GBR
	12	620-0VV	BALL BEARING 6200VVCMP2S	2	
	13	953-038	WASHER	1	
	14	953-039	INNER COVER	1	
	15	953-040	TAPPING SCREW D5X20	11	
	16	953-041	BODY ASS'Y	1	INCLUD.17
	17	953-042	METAL	2	
	18	953-043	WASHER	1	
	19	953-125	DRIVE PULLEY	1	
	22	939-542	RETAINING RING FOR D12 SHAFT (10 PCS.)	1	
	23	944-954	BEARING WASHER	1	
	24	944-109	FEATHER KEY 3X3X8	1	
	25	953-046	GEAR	1	
	26	953-047	PINION	1	
	27	620-0VV	BALL BEARING 6200VVCMP2S	1	
	28	608-DDM	BALL BEARING 608DDMC2EPS2S	1	
	29	953-048	GEAR COVER	1	
	30	949-243	MACHINE SCREW M5X25 (10 PCS.)	3	
	31	953-050	PULLEY (A)	1	

\*: ALTERNATIVE PARTS

02 - 91

## PARTS

SB - 110

ITEM NO.	CODE NO.	DESCRIPTION	NO. USED	REMARKS
32	953-051	PULLEY (B)	1	
33	936-196	BELT	1	
34	953-052	BELT COVER	1	
35	953-053	DUST FAN	1	
36	953-054	DUST GUIDE	1	
37	953-055	DUST COVER	1	
38	949-243	MACHINE SCREW M5X25 (10 PCS.)	2	
39	949-454	SPRING WASHER M5 (10 PCS.)	2	
40	957-580	TAPPING SCREW D5X30	2	
41	953-056	BELT TENSIONER ASS'Y	1	INCLUD.42A - 55
42A	953-057	IDLE PULLEY ASS'Y	1	INCLUD.43A
43	953-042	METAL	2	TILL 10.1987
43A	987-072	METAL	2	SINCE 11.1987
44	953-043	WASHER	2	
45A	953-080	FORK	1	
46	953-081	SHAFT	1	
47	939-542	RETAINING RING FOR D12 SHAFT (10 PCS.)	1	
48A	953-082	HOLDER PLATE	1	
49	953-083	SPRING	1	
50A	953-084	LEVER	1	
51	953-085	SPRING	1	
52	949-754	HEX. SOCKET HD. BOLT M4X16 (10 PCS.)	1	
53A	876-465	NYLON NUT M4	1	
54	949-429	BOLT WASHER M4 (10 PCS.)	1	
55	953-086	DISTANCE PIECE	1	
56A	953-087	BELT TENSIONER COVER	1	
* 57	949-453	SPRING WASHER M4 (10 PCS.)	3	FOR GBR
58	949-218	MACHINE SCREW M4X14 (10 PCS.)	3	
59	953-088	STRIKING GUIDE	1	
60A	949-217	MACHINE SCREW M4X12 (10 PCS.)	5	
* 61	500-223Z	CORD	1	(CORD ARMOR D10.7)FOR SIN
* 61	500-226Z	CORD	1	(CORD ARMOR D8.2)FOR OCEANIA
* 61	500-231Z	CORD	1	(CORD ARMOR D8.2)FOR SAF
* 61	500-234Z	CORD	1	(CORD ARMOR D8.2)FOR EUROPE
* 61	500-239Z	CORD	1	(CORD ARMOR D10.7)
* 61	500-240Z	CORD	1	(CORD ARMOR D8.2)FOR USA
* 61	500-420Z	CORD	1	(CORD ARMOR D10.7)FOR SAU(127V)
* 61	500-423Z	CORD	1	(CORD ARMOR D8.2)FOR SAU(220V)
* 61	953-115Z	CORD	1	(CORD ARMOR D8.2)FOR GBR
* 63	958-049Z	CORD ARMOR D8.2	1	
* 63	940-778	CORD ARMOR D10.7	1	
64	937-631	CORD CLIP	1	
65A	984-750	TAPPING SCREW (W/FLANGE) D4X16	2	
* 66	956-632	SWITCH (B) (2P SCREW TYPE) W/LOCK	1	
* 66	931-573	SWITCH (2P PILLAR TYPE) W/LOCK	1	FOR GBR,SWE,AUT,NOR,HOL
* 66	953-178	SWITCH (2P PILLAR TYPE) W/SAFETY LOCK	1	FOR FRA
67	954-017	TAPPING SCREW D4X12	1	
* 68	994-273	NOISE SUPPRESSOR	1	FOR GBR,FRG,FRA,HOL,SWE,AUT,NOR,ITA, DEN,ESP
* 69	953-116	SWITCH (TUMBLER 2P)	1	
* 69	953-112P	SWITCH (TUMBLER 2P)	1	FOR CAN

**PARTS**

**SB - 110**

ITEM NO.	CODE NO.	DESCRIPTION	NO. USED	REMARKS
*	89	953-124Z	SWITCH ASS'Y (TUMBLER 2P)	1 INCLUD. 102 FOR USA
*	70	959-140	CONNECTOR 50091 (10 PCS.)	3
72	953-089	HANDLE COVER	1	
73A	958-838	TAPPING SCREW (W/WASHER) D4X25	4	
75	953-070	ADJUSTING SCREW	1	
76	953-071	SPRING	1	
77	953-072	HANDLE KNOB	1	
78	953-073	SHOE CUSHION	1	
79	953-074	SHOE PLATE	1	
81A	999-038	CARBON BRUSH (1 PAIR)	2	TILL 6.1983
81B	999-038	CARBON BRUSH (1 PAIR)	2	SINCE 7.1983
*	82	940-540	BRUSH CAP	2
*	82	937-949	BRUSH CAP	2 FOR AUT
*	84	NAME PLATE	1	
85	957-561	HITACHI LABEL	1	
86	953-078	DUST BAG	1	
87	953-080	SANDING BELTS 110X820 WA40 (10 PCS.)	1	
88	953-081	SANDING BELTS 110X820 WA60 (10 PCS.)	1	
89	953-082	SANDING BELTS 110X820 WA80 (10 PCS.)	1	
90	953-083	SANDING BELTS 110X820 WA100 (10 PCS.)	1	
91	953-084	SANDING BELTS 110X820 WA120 (10 PCS.)	1	
*	92A	953-079	RUBBER PLATE	1 TILL 12.1978
*	92B	953-117	SWITCH COVER (TUMBLER)	1 SINCE 1.1978
*	94	959-141	CONNECTOR 50092 (10 PCS.)	2
*	95	983-243	SUPPORT	1 FOR NOISE SUPPRESSOR
96	953-110	PLATE	1	
*	97	940-509	RIVET D2.5X3.2 (10 PCS.)	4
98	938-307Z	PILLAR TERMINAL	1	
99	981-373	TUBE (D)	2	
100	940-440	WASHER (BRASS) M3.5 (10 PCS.)	2	
*	102	958-308Z	PILLAR TERMINAL (A)	2

