

S30

CG-MCB

Serial No.

S30-01 CG-MCB MINI CULTI

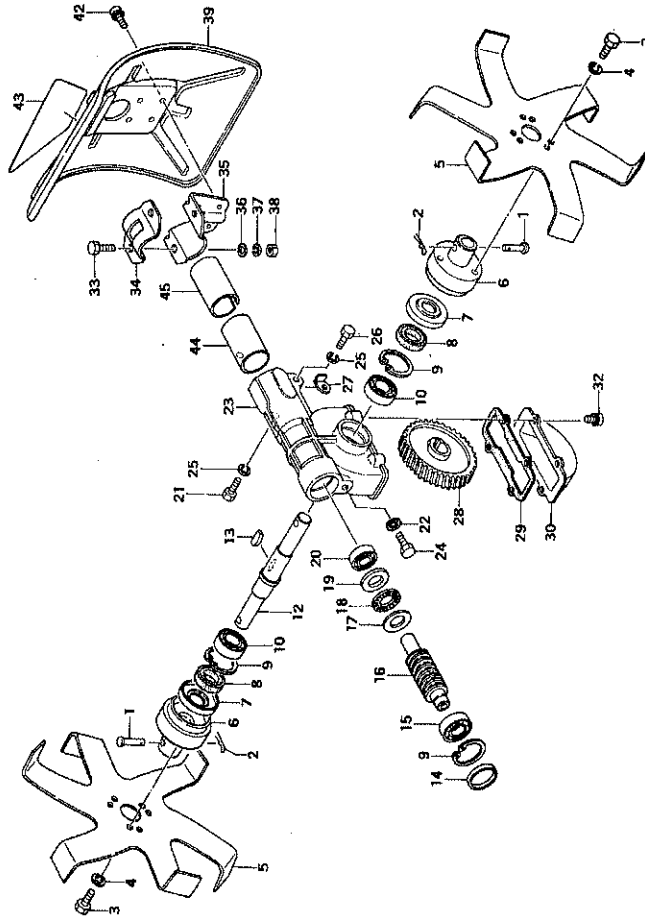

REF. NUMBER	PARTS NUMBER	DESCRIPTION	Q'TY	SERIAL NUMBER
001	668-9818	LOCK PIN	2	
002	669-3558	SNAP PIN 8	2	
003	669-4982	BOLT 6X12	6	
004	669-5219	S.WASHER 6	6	
005	669-3557	CUTTER	2	
006	668-9035	CUTTER HOLDER	2	
007	668-8987	PROTECTION COVER	2	
008	669-5639	OIL SEAL 15286	2	
009	668-4741	STOP RING C-28, INNER	3	
010	669-5583	BALL BEARING 6902, 28MM	2	
012	668-8952	DRIVE SHAFT	1	
013	668-7078	WOOD-RUFF KEY 5X22X7X	1	
014	668-9152	GEAR CASE CAP	1	
015	669-5531	BALL BEARING 6001ZZ, 28M	1	
016	668-5586	WORM SHAFT	1	
017	669-5614	THRUST WASHER 1226	1	
018	669-5613	THRUST NEEDLE BRG 2X4.	1	
019	668-9151	STEP WASHER	1	
020	669-5582	BALL BEARING 6901ZZ, 24M	1	
021	669-4982	BOLT 6X12	1	
022	669-2685	DRAIN GASKET	1	
023	668-8824	GEAR CASE	1	
024	669-4982	BOLT 6X12	1	
025	669-5219	S.WASHER 6	2	
026	669-4988	BOLT 6X25	1	
027	668-8309	SPACER	1	
028	668-8886	GEAR WHEEL	1	
029	668-9116	GEAR CASE GASKET	1	
030	668-9153	GEAR CASE COVER	1	
032	669-5333	SCREW 5X10/S	4	
033	669-4985	BOLT 6X18	2	
034	669-0303	COVER BRACKET, 26 DIA.	1	
035	669-0337	COVER HOLDER	1	
036	669-5183	SMALL WASHER 6	2	
037	669-5219	S.WASHER 6	2	
038	668-4792	NUT M6	2	
039	669-0279	SAFETY COVER	1	
042	669-5384	SCREW 5X14/PS	4	
043	669-4293	NAME PLATE CG-MCB	1	

S30-01 CG-MCB MINI CULTI

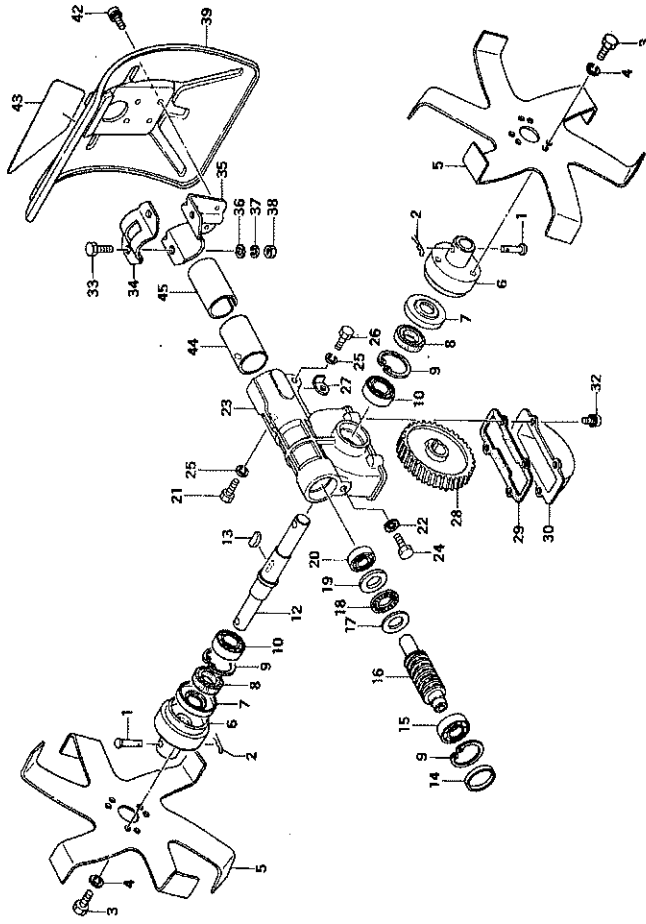

REF. NUMBER	PARTS NUMBER	DESCRIPTION	QTY	SERIAL NUMBER
044	668-9530	COLLAR B	1	
045	668-8629	COLLAR	1	